

前言

尊敬的用户：

感谢您使用九阳电饼铛（煎烤机）。本说明书仅适用于JK30U-D1。书中所有内容仅供用户使用和维护时参考，未尽事宜，欢迎向本公司的客户服务部门咨询。

愿九阳电饼铛（煎烤机）给您的生活带来温馨、便捷和健康。

目录

| | |
|-----------------|----|
| 第一章 安全注意事项 | 1 |
| 第二章 产品部件名称 | 3 |
| 第三章 使用方法 | 4 |
| 第四章 清洁及保养 | 7 |
| 第五章 故障分析及排除 | 7 |
| 第六章 产品基础信息和装箱明细 | 8 |
| 第七章 电气原理图 | 8 |
| 有害物质限制使用标识表 | 9 |
| 售后服务 | 10 |

第一章 安全注意事项

⚠ 警告：对可能导致人员危险、重伤、重大财产损失的风险要警惕。

工作期间，产品前部、左右侧和上部等表面温度会升高，贴有“高温表面”符号  的区域 / 表面，工作过程中会变烫，请注意避免烫伤。

⚠ 注意：对可能导致人员受伤或物品损害的风险要关注。

1. 本产品仅供家庭使用，请勿作为其他用途。
2. 本产品不打算由存在肢体、感官或精神能力缺陷或缺少使用经验和知识的人（包括儿童）使用，除非有负责他们安全的人对他们进行与器具使用有关的监督或指导。应照看好儿童，确保他们不玩耍本产品。
3. 打开包装后，请即刻将塑料袋放入垃圾桶，以免儿童玩耍，造成窒息的危险。
4. 本产品输入电压为120V,频率为60Hz，在将产品连接电源之前，请检查是否与当地的电源电压相符，高或低于此电压可能会损坏元器件或影响产品使用性能。为避免造成损失，建议使用稳压器。
5. 本产品为I类电器，使用前请确保接地线接地良好，以免发生漏电事故。
6. 必须单独使用15A或以上带接地的插座，插头需彻底插入插座，以防接触不良而导致元件过热烧坏，引发短路或火灾等危险。
7. 请勿在外接定时器或独立的遥控控制系统的方式下运行该产品，以防短路、自燃等危险。
8. 本产品仅用于煎烤食材，请勿用本产品进行煮水、熬粥、油炸等操作，否则易造成产品短路、器件损坏。
9. 严禁用湿手插、拔电源插头，以免触电。
10. 请在水平台面上操作，请勿在地毯、毛巾、塑料、纸等易燃物上操作本产品，以防引起火灾。
11. 请勿将本产品放在不平稳、潮湿、高温、光滑、不耐热的台面上使用，以免触电、起火、滑落等造成伤害事故和财产损失。

12. 请勿将本产品靠近高温、强磁、易燃易爆气体（如天然气、沼气等），以防引起器件损坏、故障或火灾。产品四周应留足够空间，与周边物体至少保持10cm距离。
13. 请勿在窗帘、壁橱等可燃材料下方或附近使用本产品，防止引起火灾。
14. 切勿在无人照看的情况下让产品工作，以防烤焦食材引发火灾等危险。
15. 确保电源线不会与尖锐的边缘、毛边、其他突出尖锐物或表面高热的物品接触，以防漏电，造成触电或火灾。
16. 本产品不得长时间空烧（不放置任何食材），以防过热引起烤盘崩裂、自燃等，造成伤害事故和财产损失。建议不要连续使用超过3小时。
17. 打开上盖时不能用力过大，以免上烤盘回弹造成烫伤或砸伤。
18. 产品工作时，请勿将任何袋装、罐装或瓶装物品放在产品上或烤盘内，否则有爆炸的危险。
19. 使用本产品时，请勿将过大尖锐物及纸类、塑料等易燃物品放于烤盘内，否则会造成器件损坏、火灾等危险。
20. 产品工作中、使用后冷却之前，严禁用手触摸烤盘，以防烫伤。
21. 烹饪时请使用本产品配带的竹铲，请勿使用金属或尖锐物体刮擦烤盘，以避免损坏产品或造成意外伤害。
22. 及时擦拭溢出油，切勿让油污流入产品内部，以防造成短路、触电引发人身损害、财产损失风险。
23. 取出食物时请小心高温，以免烫伤。
24. 请勿用刀或金属器具在烤盘内切割食物；请勿用金属或粗糙之物刷擦拭烤盘，以免损坏不粘涂层。
25. 使用完毕，请切断电源，待机器冷却后清洁烤盘及表面，以防残留的食材、油渍等在烘烤时冒烟或起火。
26. 本产品使用完毕后烤盘表面仍有余热，请冷却后再进行清洁，以防烫伤。
27. 无人使用本产品时、清洁或移动本产品时、产品出现故障时，请务必拔掉电源插头，防止漏电或意外启动造成损害。
28. 拔下插头时，须握住插头拔出，切勿用力猛拉或扭曲电源线，以防电源线损坏，产生漏电危险。
29. 如果电源线损坏，为了避免危险，必须由制造商、其维修部或类似部门的专业人员更换。
30. 请勿将本产品放在水或其他液体中冲洗或浸泡，不要对其喷洒水，以

免器件损坏或漏电。

31. 如产品发生故障或损坏, 请停止使用, 可以送到我公司的售后服务点维修, 切勿自行修理, 以免发生危险。
32. 丢弃本产品时, 请剪断电源线并交由有相关资质的部门回收丢弃。

温馨提示

- 产品首次使用时, 会蒸发出少量油烟, 属正常现象。
- 使用时因内部温度变化, 零部件收缩或膨胀时发出“呜呜”声, 属正常现象。

第二章 产品部件名称

● JK30U-D1

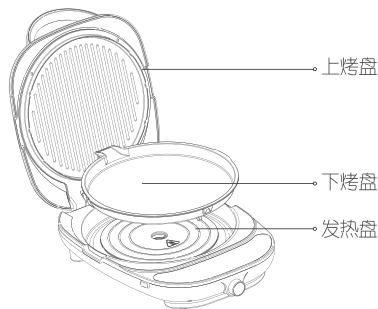
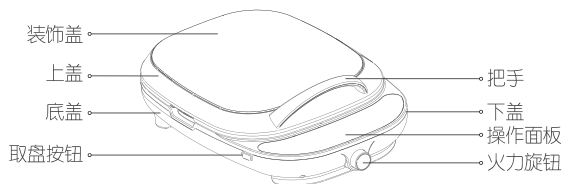

第三章 使用方法

1. 第一次使用前, 先用湿布将烤盘擦拭干净, 上下烤盘擦上少量食用油。

2. 待机状态

- | | |
|----------|---|
| JK30U-D1 | 插上电源插头, 按出火力旋钮, 蜂鸣器短鸣一声, 全部指示灯闪亮, 机器进入待机状态。 |
| JK30U-D1 | 插上电源插头, 蜂鸣器短鸣一声, 全部指示灯闪亮, 机器进入待机状态。 |

3. 产品预热

- | | |
|----------|---|
| JK30U-D1 | 按“功能选择”键, 选择需要的菜单, 对应菜单的指示灯亮, 数码屏显示烹饪时间; 再按“启动/取消”键, 预热指示灯闪亮, 电饼铛(煎烤机)开始进入预热状态, 蜂鸣器发出10声蜂鸣提示预热完成, 自动转入烹饪状态。 |
|----------|---|

4. 食物烹饪操作

在烤盘中放入将要烤制的食物后盖好上盖。

- | | |
|----------|---|
| JK30U-D1 | 待机状态下, 按“功能选择”键, 可循环选择各种烹饪功能; 功能选定后可按“+”、“-”键进行时间调整; 按“烤盘选择”键可选择调整上盘、下盘加热; 操作火力旋钮可选择不同的温度点(仅“自主煎烤”功能时才能使用)。 |
|----------|---|

●食物加工参照表

| 食品名称 | 时间(分钟) |
|-------------------------|--------|
| 煎鸡蛋、薄饼、鸡蛋饼、煎饼、春饼、葱花饼 | 2~5 |
| 大饼、馅饼、锅贴、肉饼、烙馍、家常饼 | 4~8 |
| 发面饼、玉米饼、豆馅饼、各种烧饼 | 4~7 |
| 烤肠、烤肉、烤羊肉串、煎鱼、油焖大虾 | 4~8 |
| 烤土豆片、薯片、三明治面包 | 4~5 |
| 炒豆、炒花生米、炒瓜子、爆米花、炒栗子、披萨饼 | 4~10 |

●备注

上表时间仅供参考, 烤制时间与电压、气温及食物的用料、软硬、大小等有关, 且各地对事物的习惯称呼不同, 可根据具体实际情况进行合理调整。

- 当烹饪完成后, 煎烤机发出烹饪结束蜂鸣提醒, 转入待机状态。
- 使用完毕, 断开电源开关, 拔下电源插头, 先冷却几分钟, 用湿抹布擦拭干净即可, 但长期不用时应使用清洁剂进行清洗。

●上烤盘180° 摊平方法

在上烤盘打开95°左右“立式”放置时, 握住把手稍向上用力使上烤盘离开卡位, 继续自然顺着转槽旋至180°, 此时把手支撑上烤盘, 整个产品处于摊平状态。(如下图)

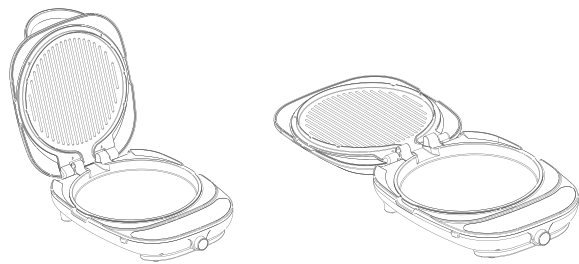

●取盘方法:

在95°或180°打开状态下, 按下取盘键, 待下烤盘弹起后取出即可。(如下图)

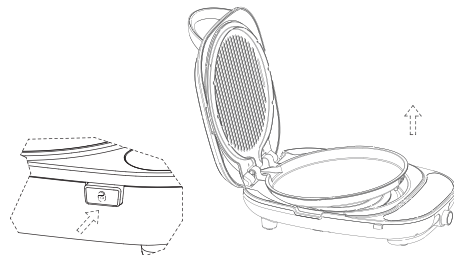

●烤盘安装方法:

在95°或180°打开状态下, 将下烤盘向后插入机体相应定位孔, 再将下烤盘向下按, 听到响应声即安装到位。(如下图)

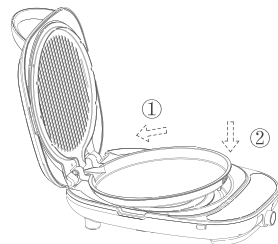

小贴士

- 为保证食物健康, 请勿重复使用烹饪过的油。
- 烙薄饼时为使上下效果均匀一致, 建议烙制过程中适时的进行翻面。

第四章 清洁及保养

- 清洁产品前请先关闭电源，拔下电源线插头。
- 待烤盘冷却后，用干净湿毛巾将上烤盘擦拭干净，下烤盘可取出清洗。请勿用钢丝球等粗糙物品擦拭烤盘，防止破坏涂层。如果长期存放，应使用清洁剂进行清洗。
- 切勿将整个电饼铛（煎烤机）浸入水中清洗，以免发生触电危险或功能故障。
- 清洁完毕，待产品晾干后放置于阴凉干燥处保存。

第五章 故障分析及排除

| 故障现象 | | 产生原因 | 解决方法 |
|-----------|----------|---------------|----------------------|
| 机器 不加热 | 线路板指示灯不亮 | 电源没有接通 | 检查插头插座、电源引线是否完好，并插到位 |
| | | 内部导线断开 | 送指定的售后服务部进行维修 |
| | 线路板损坏 | | |
| | 线路板指示灯亮 | 电热管损坏 | 送指定的售后服务部进行维修 |
| 电热管导线损坏 | | | |
| 不能自动限温 | 温度传感器损坏 | 送指定的售后服务部进行维修 | |

- 如问题不能解决，切勿私自拆卸机器。请送当地售后服务部进行维修，详情请查阅说明书中“售后服务”相关内容或拨打阳光服务热线：1-888-968-8898进行咨询。
- 以上内容如因型号或零部件变更与实物不符，请以实物为准，恕不另行通知，敬请谅解！

第六章 产品基础信息和装箱明细

| | | |
|-----------------|-----------------------|-------|
| 产品型号 | JK30U-D1 | |
| 产品尺寸（长 × 宽 × 高） | 397mm × 290mm × 133mm | |
| 产品净重 | 约 4kg | |
| 技术参数 | 额定电压 | 120V |
| | 额定频率 | 60Hz |
| | 额定功率 | 1600W |
| | 烤盘直径 | 30cm |
| 装箱明细 | 整机 | 1 台 |
| | 竹铲 | 1 把 |
| | 说明书 | 1 本 |

（所有数据由九阳研发中心提供，若有变更恕不另行通知）

第七章 电气原理图

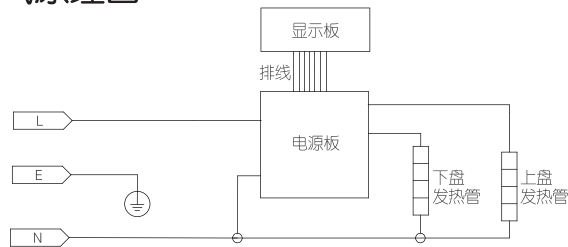

有害物质限制使用标识表

有害物质的名称和含量表

| 部件名称 | 有害物质 | | | | | |
|---------------------------------------|-------|-------|-------|-------------|-----------|-------------|
| | 铅(Pb) | 汞(Hg) | 镉(Cd) | 六价铬(Cr(VI)) | 多溴联苯(PBB) | 多溴二苯醚(PBDE) |
| 与食品接触的配件(炸锅*、烤盘*、搅拌叶片*等) | ○ | ○ | ○ | ○ | ○ | ○ |
| 橡胶件(密封圈、脚垫等) | ○ | ○ | ○ | ○ | ○ | ○ |
| 非阻燃塑料结构件(外壳*、侧板*、上盖*等) | ○ | ○ | ○ | ○ | ○ | ○ |
| 不锈钢结构件(提手*、连接件*、轴*等) | ○ | ○ | ○ | ○ | ○ | ○ |
| 其它金属结构件(外壳*、内腔体*、盖板*、反射板*等) | ○ | ○ | ○ | ○ | ○ | ○ |
| 标准件(螺钉、螺母等) | ○ | ○ | ○ | ○ | ○ | ○ |
| 玻璃陶瓷结构件(视窗玻璃*、玻璃盖*等) | ○ | ○ | ○ | ○ | ○ | ○ |
| 阻燃结构件(插座*、开关支架*、电机支架*等) | ○ | ○ | ○ | ○ | ○ | × |
| 电器件、印刷线路板组件*(PCB板、电容、变压器等)、电机*、电源线、线束 | × | ○ | × | ○ | ○ | × |

○：表示该有害物质在该部件所有均质材料中的含量均在GB/T 26572规定的限量要求之下。

×：表示该有害物质至少在该部件的某一均质材料中的含量超出GB/T 26572规定的限量要求。

*“/”的部件表明，由于目前全球的技术和工艺水平限制而无法实现非环保类物质或元素的完全替代，后续随着技术上的改进将逐步改进。

*：表示仅部分型号产品含该部件。



有害物质限制使用标志

环保使用期限10年：表示本产品中含有的有害物质不会发生外泄或突变，用户在产品说明书所述情况下正常使用本产品不会对环境造成严重污染或对其人身、财产造成严重损害的期限。

前头循环标志：表示本产品可回收利用。超过使用期限或经过维修无法正常工作后，不应被随意丢弃，请交由正规回收渠道以及有废弃电器电子产品处理资格的企业处理，正确的处理方法请查阅国家或当地有关旧电器

以上标识均依据中国有害物质限制使用管理办法及其配套标准SJ/T 11364要求执行。本产品长期使用不会对人体产生危害，请放心使用。

售后服务

服务条款

1. 本产品执行全国三包规定，整机包修1年。三包有效期自开具发票之日起计算，三包范围仅限家庭使用。
2. 购机发票作为产品三包凭证。
3. 九阳用户尊享产品服务过程中的免费保洁、保养、检测服务。

非三包范围

1. 消费者因搬运、使用、维护、保管不当造成产品损坏；
2. 无有效发票或购买证明的，且无法证明属于三包期内的；
3. 发票与实物不符或涂改的；
4. 因不可抗拒的自然灾害造成损坏的；
5. 超过三包期的；
6. 使用环境（如电压、湿度、温度、通风条件等）不符合产品说明书的表述，造成损坏的；

Foreword

Dear Customer:

Thank you for choosing Joyoung's Electric Baking Pan (Electric Grill). This instruction manual pertains to models JK30U–D1. The contents of the manual are intended for reference regarding operation and maintenance. If you have any questions, please feel free to contact our customer service department.

We hope that your Joyoung Baking Pan (Electric Grill) will brighten your lifestyle with warmth, convenience, and health.

Contents

| | |
|--|----|
| Chapter I – Safety Precautions | 1 |
| Chapter II – Product components | 3 |
| Chapter III – Operating instructions | 4 |
| Chapter IV – Cleaning and maintenance | 7 |
| Chapter V – Error identification and troubleshooting | 8 |
| Chapter VI – Basic product information and packing details | 9 |
| Chapter VII – Electrical schematic diagram | 9 |
| Hazardous materials restricted use identification chart | 10 |
| After sales customer support | 11 |

Chapter I

Safety Precautions



Warning: Be aware of risks that could result in death, serious personal injury, or significant property damage.

During operation, the front, sides, and top of the machine will have an elevated temperature. Areas labeled with a  symbol indicate that the surface will become hot during operations, please be careful to prevent burns.



Attention: Be aware of risks that could result in personal injury or property damage.

1. This product is designed and intended for home use, please refrain from using it for other purposes.
2. This product is not intended to be operated by persons (including children) who may lack the physical, sensory, or mental faculties required to do so or lack experience, unless under the strict supervision of individuals responsible for their safety or guidance. Please prevent children from playing with the machine in any circumstance to ensure their safety.
3. After opening the packaging, please immediately throw any plastic bags into the trash as to prevent children from playing with them.
4. This product is designed for use with a voltage of 120V and a frequency of 60Hz. Prior to connecting the power supply, please check that the local power voltage is appropriate. A voltage higher or lower than the rated voltage may damage the machine or affect its functionality. To prevent causing damage to the machine, it is recommended to use a voltage stabilizer.
5. This product is a Class I Electrical Appliance. Please ensure that the grounding wire is properly grounded prior to use to avoid electrical leakage accidents.
6. It is necessary to only use 15A or higher grounded sockets and to securely connect the power plug completely to prevent overheating which may cause short-circuiting, fire hazards, and other dangers.
7. Do not operate the product with an external timer or independent remote control system to prevent short-circuiting, combustion, and other dangers.
8. This product is intended for grilling purposes. Do not use this product to boil water, cook porridge, fry, or other functions to prevent short circuiting and property damage.
9. Do not plug or unplug the machine into a power socket with wet hands to prevent getting shocked.

10. Please use the machine on a flat, level surface. Do not set up the machine on top of carpet, a towel, plastic, paper, or other flammable materials to prevent the risk of combustion.
11. Do not set up the machine on uneven, wet, hot, slippery, or heat sensitive surfaces to prevent potential injury or property damage.
12. Do not put this product near high temperatures, strong magnets, flammable or explosive gases (natural gas, methane, etc.) to prevent damage to the machine and risks of combustion. Maintain a distance of at least 10cm from it and its surrounding objects.
13. Do not use this product under or near flammable materials such as curtains or closets to prevent fire hazards.
14. Never operate machine operate without anyone overseeing the procedure to prevent burning food and fire hazards.
15. Ensure that the power cord is not in contact with sharp objects or hot surfaces and objects to prevents risks of electrical leakage, electrical shock, and fire hazards.
16. This product is not designed to handle extended operation with no food inside, doing so may result in cracking the pan or igniting the machine, potentially causing injury or property damage. It is not recommended to use the machine continuously for more than 3 hours.
17. Do not use excessive force when lifting the lid to prevent the pan from bouncing back and colliding with or burning the user.
18. When using the machine, do not put any bagged, canned, or bottled items on the pan to prevent risks of exploding.
19. When using the machine, do not put very sharp objects, paper, plastic, or other flammable materials in the pan to prevent risks of property damage and fire hazards.
20. Do not touch the pan with your bare hands during operation or afterwards before the machine has cooled down to prevent burns.
21. Please use the included bamboo spatula while cooking. Do not use metal or sharp objects to scrape the surface to prevent damage to the product.
22. Please quickly clean oil spills to avoid oil from seeping into the machine's interior, preventing risks short-circuiting, electrical shock, and damage to or loss of property.
23. Be careful when removing food from the machine as it will be very hot.
24. Do not use knives or metal tools to cut food on the pan; Do not use metal or rough materials to clean the pan as it may damage the coating.
25. After completing operations, unplug the power cord, wait until the machine has cooled down, then clean the pan as well as the surface. Residual scraps of food and grease may create smoke or fire hazards in later use.

26. After using the machine, the surface of the pan will have residual heat. Wait until the machine has cooled down before proceeding to clean to prevent burns.
27. When cleaning or moving the machine, when the machine malfunctions, or when the machine is not being used, unplug the power cord to prevent electrical leakage.
28. When unplugging the power grip, maintain a firm grip on the plug and refrain from using excessive force as to not damage the cord and present a risk of electric leakage.
29. If the power cord is damaged, to ensure personal safety, it is necessary to contact the manufacturer or professional repair and maintenance personnel to replace the component.
30. Do not rinse or submerge this product in water or other liquids or spray the machine with alcohol to avoid damaging the product or creating electric leakage.
31. If the product malfunctions or is damaged, stop using the machine and contact Joyoung after sales customer service for maintenance and repair. Do not attempt to repair the machine yourself to avoid danger.
32. If you decide to discard this product, please sever the power cord and deliver the machine to a qualified location for recycling and disposal.

Reminder

- When using this product for the first time, it is normal for it to emit a small amount of fumes.
- It is normal for the machine to emit clicking noises during operation as the internal temperatures fluctuate, expanding and contracting the components.

Chapter II Product Components

● JK30U-D1

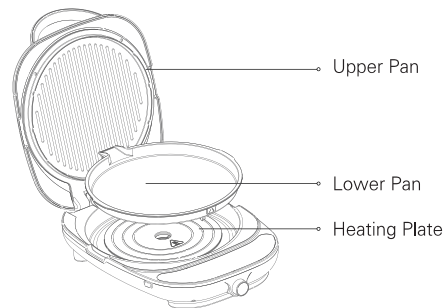
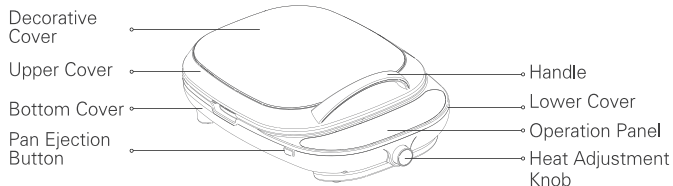

Chapter III Operating Instructions

1. Prior to the initial use, use a wet cloth to clean the baking pans. The upper and lower pan are brushed with a small amount of cooking oil.

2. Standby mode

| | |
|----------|--|
| JK30U-D1 | Connect the power plug and press the heat adjustment knob. The buzzer will beep once, all the indicator lights will flash, and the machine will enter standby. |
| | Connect the power plug. The buzzer will beep once, all the indicator lights will flash, and the machine will enter standby. |

3. Machine preheating

| | |
|----------|--|
| JK30U-D1 | Press the "function" button and select the desired option. The corresponding indicator light will illuminate and the digital panel will display the cooking time. Proceed by pressing the "start/cancel" button and the preheat indicator light will illuminate, and the electric baking pan (electric grill) will enter preheating mode. When the machine is finished preheating, the buzzer will emit 10 beeps to indicate completion and will automatically transition into cooking mode. |
|----------|--|

4. Cooking operation

Place the food to be baked in the pan and cover it.

JK30U-D1

When the machine is in standby, press the “function” button, each press will cycle through the list of available options. After selecting the desired function, press the “+” or “-” buttons to adjust the time setting. Press the “heating method” to select if the heat is applied through the top pan, bottom pan, or both. The heat adjustment knob may be used to set different specific temperatures (this is only available when using the “manual grilling” function).

● Cooking time reference table

| Food Name | Time (minutes) |
|--|----------------|
| Fried eggs, Chinese tortillas, egg pancakes, Chinese crepes, spring rolls, scallion pancakes | 2 ~ 5 |
| Chinese pancakes, Chinese pies, pot stickers, meat pies, tortillas, homestyle Chinese pancakes | 4 ~ 8 |
| Chinese flatbread, corn bread, bean stuffing cakes, assorted Chinese biscuits | 4 ~ 7 |
| Sausages, roast meat, lamb kebabs, fried fish, fried shrimp | 4 ~ 8 |
| Baked potato wedges, potato chips, sandwich bread | 4 ~ 5 |
| Fried beans, fried peanuts, fried melon seeds, popcorn, fried chestnuts, pizza | 4 ~ 10 |

● Remarks

The durations in the above table is for reference only. The appropriate times required should be adjusted relative to voltage, temperature, ingredients, hardness, size and other factors. The customary names of each dish may also vary based on different regions and cultures, and settings should be adjusted according to the actual situation.

- When the cooking is finished, the machine will emit beeping noises to indicate completion before transitioning back to standby mode.
- After using the machine, disconnect the power switch, unplug the power cable, wait a few minutes for the machine to cool down and use a damp towel to wipe down the pans. If the machine will remain in storage for an extended period, use dishwashing detergent to sanitize the pans.

● Upper Pan 180° Levelling Method

Lift the upper pan to a vertical position so that it is perpendicular to the base. Grip the handle and gently lift upwards until the pan is removed from its socket and let the pan naturally continue rotating until the handle connects with the flat surface and is supporting the weight of upper half, at which point an angle of 180° is reached (as pictured below)

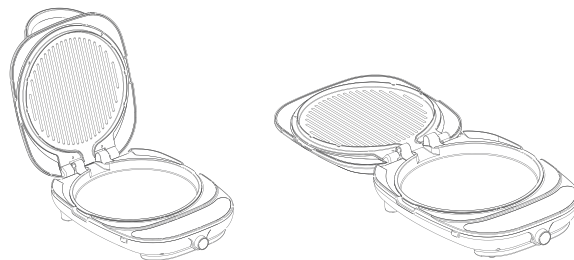

● Pan Ejection Method:

Open the pan to a 95° or 180° angle and press the pan ejection button. Grab and remove the pan after it pops out from its standard position (as pictured below).

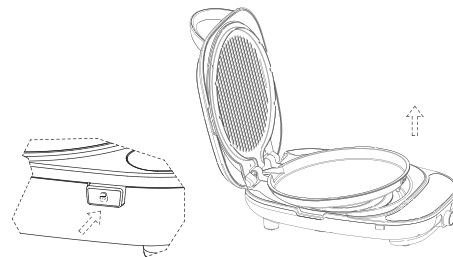

● Pan Installation Method:

Open the pan to a 95° or 180° angle, insert the lower pan into the socket towards the back of the machine before pressing the pan downwards into its correct position. There will be an audible click as it falls into place.

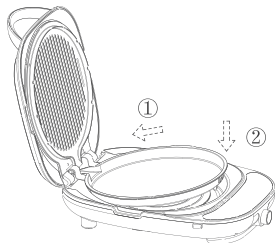

Tips

1. To ensure the healthiness of the food, please refrain from reusing oil when cooking.
2. When making tortillas, it is recommended to flip sides once during cooking to ensure the top and bottom surfaces are consistent.

Chapter IV Cleaning and Maintenance

- Disconnect the power switch and unplug the power cable before cleaning the machine.
- After the pan has cooled down, use a damp towel to wipe the pan clean. The bottom pan is removable for cleaning. Please do not use steel wool or other rough objects to scrub the pan as it may damage the coating. If the machine will remain in storage for an extended period, use dishwashing detergent to sanitize the pans.
- Do not submerge the entire electric baking pan (electric grill) in water during cleaning to prevent the risks of electrocution and damage to the machine.
- When finished cleaning, wait until the machine is dry before storing it in a cool and dry place.

Chapter V Error Identification and Troubleshooting

| Phenomenon | | Explanation | Solution |
|---|--|--|---|
| The machine won't heat up | The display indicator lights are not illuminated | The power is not connected Internal wire is disconnected Damaged circuit board | Check the power plug and socket, the power cable is intact, and if the plug is properly connected. Send to a designated after sales service center for service |
| | The display indicator lights are illuminated | Damaged heater Damaged heater circuitry | Send to a designated after sales service center for service |
| The machine cannot automatically limit the temperature. | | Damaged temperature sensor | Send to a designated after sales service center for service |

- If the issue cannot be identified or solved, do not independently disassemble the machine. Please send the machine to the local designated after sales service center for service. Please refer to the “after sales customer service” section of the manual for details or call the customer support hotline at 1-888-968-8898 for a consultation.
- If the above information is not pertinent to the actual product due to differences in model or components, please make judgements based on the actual product, thank you for understanding!

Chapter VI

Basic Product Information and Packing Details

| | | |
|--|--------------------|-----------------------|
| Product Model(s) | | JK30U-D1 |
| Product Measurements (Length * Width * Height) | | 397mm x 290mm x 133mm |
| Product Net Weigh | | Approx. 4kg |
| Technical Parameters | Rated Voltage | 120V~ |
| | Rated Frequency | 60Hz |
| | Rated Power | 1600W |
| | Pan Diameter | 30cm |
| Packing Details | Machine | 1 |
| | Bamboo Spatula | 1 |
| | Instruction Manual | 1 |

(All numbers are provided by the Joyoung Research and Development Center and are subject to change without notice)

Chapter VII

Electric Schematic

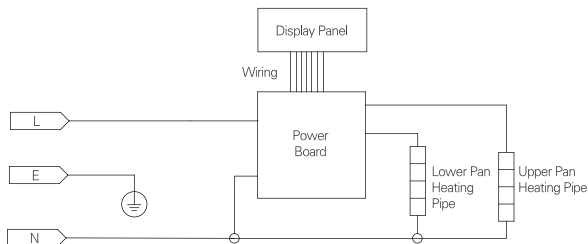

Restricted Hazardous Substance Usage Chart

Name and content list of harmful substances

| Component Name | Restricted Substance | | | | | |
|---|----------------------|------|------|--------|-------|--------|
| | (Pb) | (Hg) | (Cd) | (Cr+6) | (PBB) | (PBDE) |
| Parts in Contact with Food (Fryer*, Baking Pan*, Mixing Blade*, etc.) | ○ | ○ | ○ | ○ | ○ | ○ |
| Rubber parts (Seal Ring, rubber Feet, etc.) | ○ | ○ | ○ | ○ | ○ | ○ |
| Non-Flame-Retardant Plastic Components (Outer Shell*, Side Panel*, Top Cover*, etc.) | ○ | ○ | ○ | ○ | ○ | ○ |
| Stainless Steel Structural Components (Handle*, Connector*, Shaft*, etc.) | ○ | ○ | ○ | ○ | ○ | ○ |
| Other Metal Components (Outer shell*, Interior Compartment*, Cover*, Reflective Plate*, etc.) | ○ | ○ | ○ | ○ | ○ | ○ |
| Standard Parts (Screws, Nuts, etc.) | ○ | ○ | ○ | ○ | ○ | ○ |
| Glass Ceramic Structural Components (Display Panel Glass*, Glass Cover*, etc.) | ○ | ○ | ○ | ○ | ○ | ○ |
| Flame-Retardant Plastic Components (Power Socket*, Power Switch Bracket*, Motor Bracket*, etc.) | ○ | ○ | ○ | ○ | ○ | × |
| Motor Parts, Printed Circuit Board Assembly* (PCB Board, Capacitance, Transformer, etc.), motor*, Power Cable*, Harness | × | ○ | × | ○ | ○ | × |

- : Indicates that the quantity of hazardous substance in all homogeneous materials of the component is within the limit requirement as specified in GB/T 26572.
- ×
- * : Indicates that only certain models contain the component.



Hazardous Substances Restriction Symbol

Environmental protection service life of 10 years: The harmful substances contained in this product will not leak or suddenly change. Normal use of this product as under the conditions described in the instruction manual will not cause serious pollution to the environment or cause serious damage to people and/or property.

Recycling Symbol: Indicates that this product is recyclable. After the rated lifespan of the machine is exhausted or if the machine is not able to be restored to working order, please do not carelessly discard the unit. Please use the proper channels that are certified to recycle machines and electronics. To learn more about recycling machines, please investigate local policies and procedures regarding recycling.

The above statements are based on the Chinese hazardous substances use management measures and its supporting standards SJ/T 11364 Requirements
Please rest assured, regular and extended use of this product does not present dangers to one's health.

After Sales Customer Service

Terms of Service

1. This product implements the new national three guarantees regulations, and the warranty covers the entire machine for one calendar year. The validity period of the three guarantees is calculated using the date of purchase on the corresponding receipt. The guarantees only cover household use of the product.
2. The receipt of purchase acts as the certificate of the three-guarantees system.
3. Joyoung users can enjoy free cleaning, maintenance, and testing services during the warranty period.

Non-Three-Guarantees Parameters

1. Damage incurred through improper handling, use, maintenance or storage by the consumer.
2. No receipt or invoice with an effective date of purchase, and no proof of certification via the three-guarantees system.
3. The proof of purchase does not match the actual product or is edited.
4. Damage caused by unpreventable natural disasters.
5. Products past the warranty period.
6. Damage caused by operating conditions (including but not limited to voltage, temperature, humidity, and airflow) that do not not satisfy the standards as specified in the instruction manual.